

SITE EXTENT = 486 Sq.M  
 NO. OF PLOTS = 3 Nos.

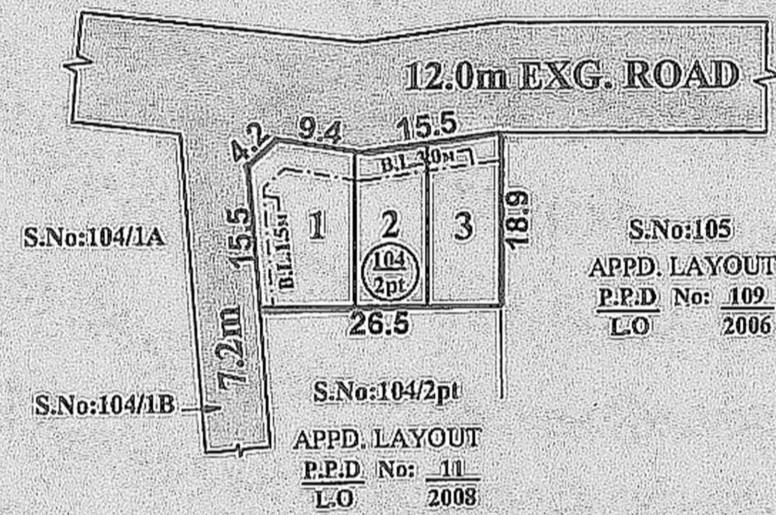

**CONDITION :**

**DR RULE NO: 29 (11)**

THE COST OF LAYING IMPROVEMENTS TO THE SYSTEMS INRESPECT OF ROAD, WATER SUPPLY, SEWERAGE, DRAINAGE OR ELECTRIC POWER SUPPLY THAT MAY BE REQUIRED AS ASSESSED BY THE COMPETENT AUTHORITY, SHALL BE BORNE BY THE APPLICANT.

**LEGEND:**

- SITE BOUNDARY
- EXISTING ROAD

**CONDITIONS:**

THE SUB-DIVISION APPROVED IS VALID SUBJECT TO OBTAINING SANCTION FROM THE LOCAL BODY CONCERNED.

P.P.D NO: 12  
 L.O 2018

**APPROVED**

VIDE LETTER NO : L1 / 512 / 2017  
 DATE : 15 / 02 / 2018

*Srinath*  
 15/02/2018  
 FOR MEMBER SECRETARY  
 CHENNAI METROPOLITAN  
 DEVELOPMENT AUTHORITY 4/5

*S. P. Srinivasan*  
 14/02/18  
 PREPARED BY P.A.IV(S.M)

*Rajalok*  
 14/02/18  
 CHECKED BY P.A.I

*S. P. Srinivasan*  
 14/02/2018  
 A.P.(S.A)

**POONAMALLEE PANCHAYAT UNION**

SKETCH SHOWING THE CONVERSION OF GREEN SPACE LYING IN THE APPROVED LAYOUT P.P.D/L.O.No:11/2008 IN TO RESIDENTIAL PLOTS IN S.Nos: 104/ 2pt OF MEPPUR VILLAGE.

SCALE : 1:800 (ALL MEASUREMENTS ARE IN METRE.)

